

REVISIONS			
REV.	DESCRIPTION	DATE	APPROVED

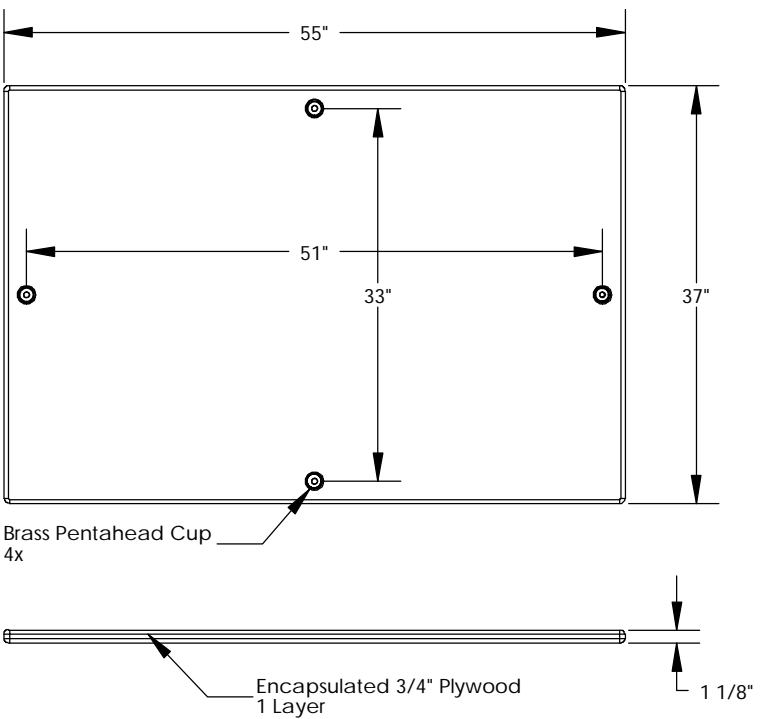
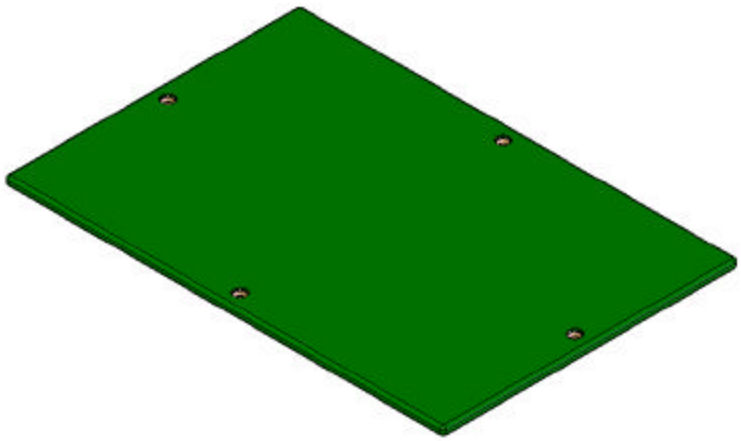

Includes (4) 3/8-16x1.5
SS Pentahead Bolts

Nordic Fiberglass, Inc.
21415 US Hwy 75 NW, Warren, MN 56762
www.nordicfiberglass.com
218-745-5095 ph. --- 218-745-4990 fax

PROPRIETARY AND CONFIDENTIAL
THE INFORMATION CONTAINED IN THIS DRAWING IS THE SOLE PROPERTY OF NORDIC FIBERGLASS, INC. ANY REPRODUCTION IN PART OR AS A WHOLE WITHOUT THE WRITTEN PERMISSION OF NORDIC FIBERGLASS, INC. IS PROHIBITED.

Customer Name: N/A			GSC-55-37-MG		
DIMENSIONS ARE IN INCHES TOLERANCES: ANGLES ± 1° FRACTIONAL ± 1/2 ONE PLACE DECIMAL ± .060 TWO PLACE DECIMAL ± .030 THREE PLACE DECIMAL ± .015			MATERIAL	SIZE	ITEM ID:
DRAWN	P.J.W.	10/27/06		A	02170.00
CHECKED	---	---		SCALE: 1:16	REV. REL-01
					SHEET 1 OF 1