

| REVISIONS |                                   |            |          |
|-----------|-----------------------------------|------------|----------|
| REV.      | DESCRIPTION                       | DATE       | APPROVED |
| REL-01    |                                   | 4/11/2007  |          |
| REL-02    | Changed from 3/4" Plywood & 2x4's | 3/4/2008   | R.L.J.   |
| REL-03    | Added (1) 2x6                     | 11/14/2012 | M.F.K.   |

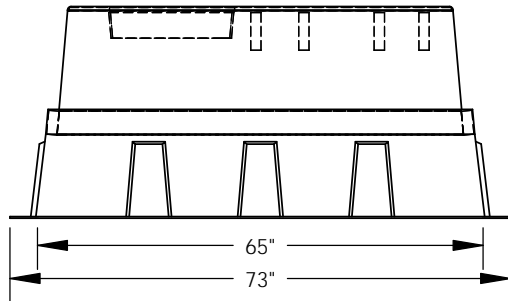
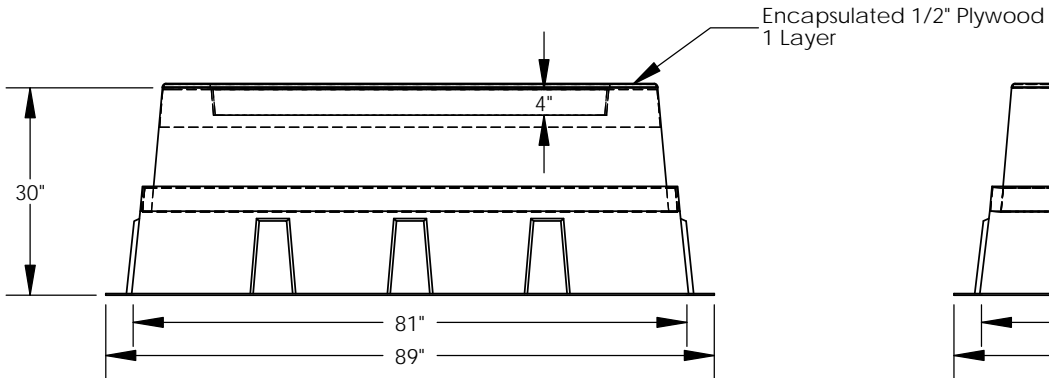
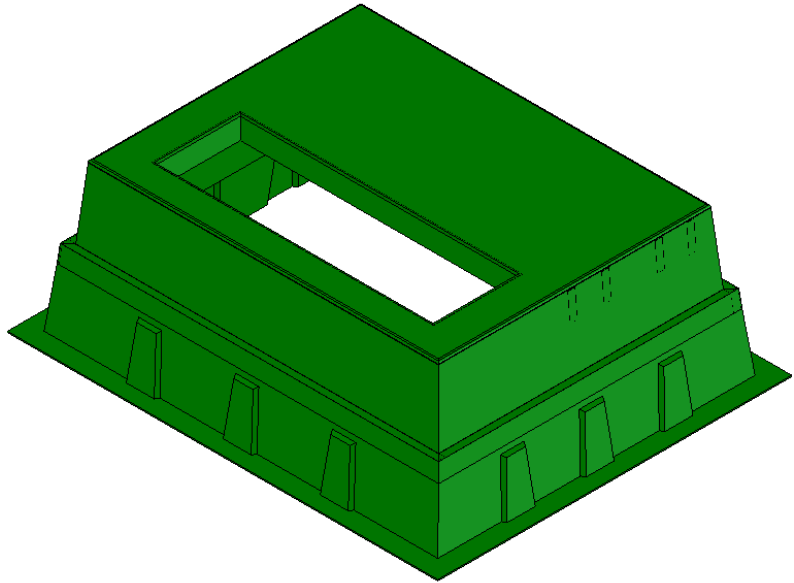
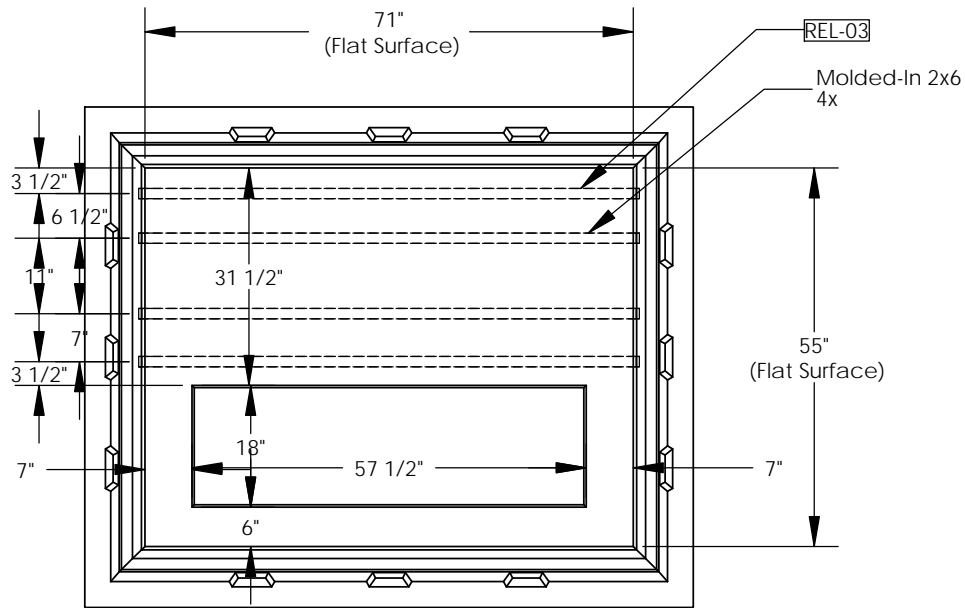

**PROPRIETARY AND CONFIDENTIAL**  
 THE INFORMATION CONTAINED IN THIS DRAWING IS THE SOLE PROPERTY OF NORDIC FIBERGLASS, INC. ANY REPRODUCTION IN PART OR AS A WHOLE WITHOUT THE WRITTEN PERMISSION OF NORDIC FIBERGLASS, INC. IS PROHIBITED.

|  |      |          |
|--|------|----------|
| Customer Name: N/A   |      |          |
| DIMENSIONS ARE IN INCHES<br>TOLERANCES: ANGLES ± 1°<br>FRACTIONAL ± 1/2<br>ONE PLACE DECIMAL ±.060<br>TWO PLACE DECIMAL ±.030<br>THREE PLACE DECIMAL ±.015 |      |          |
| MATERIAL   |      |          |
| DRAWN  | NAME | DATE     |
| P.J.W.   |      | 04/11/07 |
| CHECKED  | ---  | --/--/-- |

**Nordic Fiberglass, Inc.**  
 21415 US Hwy 75 NW, Warren, MN 56762  
 www.nordicfiberglass.com  
 218-745-5095 ph. --- 218-745-4990 fax

GS-72-56-30RT-MG-58x18

|            |              |               |
|------------|--------------|---------------|
| SIZE       | ITEM ID:     | REV.          |
| <b>A</b>   | 01690.00     | <b>REL-03</b> |
| SCALE:1:28 | SHEET 1 OF 1 |               |